

SHIELDED SURFACE-MOUNT POWER INDUCTORS

SPI0402S SERIES



FEATURES:

- Current up to 3A
- Very Small Foot Print
- Flat-top for Pick & Place

COMMON APPLICATIONS:

- Ideal for Palm-Top and Laptop DC-DC Converters
- PDA's Flash Memory
- Step-up, Step-down Converters

ELECTRICAL CHARACTERISTICS :

| Part Number SPI0402S- | L (μ H) ± 20% | DCR (Ω) Max | IDC (A) Max |
|--------------------------|------------------|---------------|---------------|
| 1R0 | 1.0 | 0.040 | 3.0 |
| 1R5 | 1.5 | 0.045 | 2.8 |
| 2R2 | 2.2 | 0.050 | 1.8 |
| 3R3 | 3.3 | 0.055 | 1.6 |
| 4R7 | 4.7 | 0.060 | 1.4 |
| 6R8 | 6.8 | 0.065 | 1.2 |
| 100 | 10 | 0.075 | 1.0 |
| 150 | 15 | 0.090 | 0.80 |
| 220 | 22 | 0.11 | 0.70 |
| 330 | 33 | 0.19 | 0.60 |
| 470 | 47 | 0.23 | 0.50 |
| 680 | 68 | 0.29 | 0.40 |
| 101 | 100 | 0.48 | 030 |
| 151 | 150 | 0.59 | 026 |
| 221 | 220 | 0.90 | 0.22 |
| 331 | 330 | 1.40 | 0.20 |
| 471 | 470 | 1.80 | 019 |
| 681 | 680 | 2.20 | 0.18 |
| 102 | 100 | 3.40 | 0.15 |
| 152 | 1500 | 4.20 | 0.12 |
| 222 | 2200 | 8.50 | 0.10 |
| 332 | 3300 | 11.0 | 0.08 |
| 472 | 4700 | 13.9 | 0.06 |
| 682 | 6800 | 25.0 | 0.04 |
| 103 | 10000 | 32.8 | 0.02 |

- Testing: (Equivalent acceptable)
Inductance: HP4285A
RDC: QuadTech 1880 Milliohm meter
-Q- HP4342A - SRF-HP4191A
- IDC Max: Determined when superimposed
DC current is decreased 10% against its initial value
- Operating Temperature: -40°C to +85°C
- Storage Temperature: -40°C to +105°C
- Solder methods: Vapor Phase, Infrared Reflow
- Resistance to soldering heat: 260°C for 10 seconds
- Solvent resistance: Conforms to MIL-STD-202E
- Marking: Inductance & Tolerance
- Note: All specification subject to change without noticed.

PHYSICAL CHARACTERISTICS

DIMENSION:(mm)

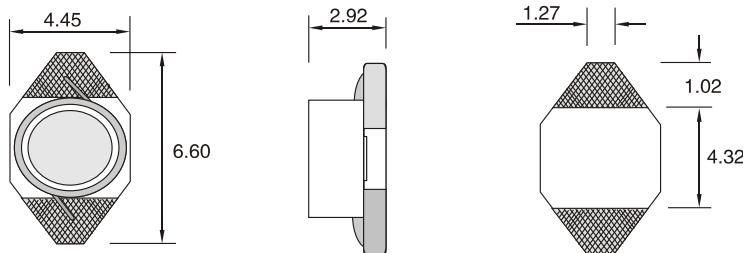

PAD LAYOUT

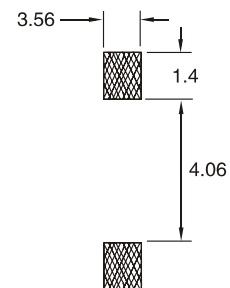

SHIELDED SURFACE-MOUNT POWER INDUCTORS

SPI0802S SERIES



FEATURES:

- Current up to 4A
- Very Small Foot Print
- Flat-top for Pick & Place

COMMON APPLICATIONS:

- Ideal for Palm-Top and Laptop DC-DC Converters
- PDA's Flash Memory
- Step-up, Step-down Converters

ELECTRICAL CHARACTERISTICS :

| Part Number SPI0802S- | L (μ H) $\pm 20\%$ | DCR (Ω) Max | IDC (A) Max |
|-----------------------|--------------------------|----------------------|---------------|
| 1R5 | 1.5 | 0.038 | 4.00 |
| 2R2 | 2.2 | 0.045 | 3.50 |
| 3R3 | 3.3 | 0.062 | 3.00 |
| 4R7 | 4.7 | 0.78 | 2.50 |
| 6R8 | 6.8 | 0.10 | 2.20 |
| 100 | 10 | 0.145 | 2.00 |
| 150 | 15 | 0.20 | 1.50 |
| 220 | 22 | 0.30 | 1.30 |
| 330 | 33 | 0.45 | 1.10 |
| 470 | 47 | 0.65 | 0.80 |
| 680 | 68 | 0.80 | 0.70 |
| 101 | 100 | 1.40 | 0.60 |
| 151 | 150 | 1.80 | 0.50 |
| 221 | 220 | 2.20 | 0.40 |
| 331 | 330 | 3.60 | 0.30 |
| 471 | 470 | 5.10 | 0.20 |

- Testing: (Equivalent acceptable)
Inductance: HP4285A
RDC: QuadTech 1880 Milliohm meter
-Q- HP4342A - SRF-HP4191A
- IDC Max: Determined when superimposed DC current is decreased 10% against its initial value
- Operating Temperature: -40°C to $+85^{\circ}\text{C}$
- Storage Temperature: -40°C to $+105^{\circ}\text{C}$
- Solder methods: Vapor Phase, Infrared Reflow
- Resistance to soldering heat: 260°C for 10 seconds
- Solvent resistance: Conforms to MIL-STD-202E
- Marking: Inductance & Tolerance
- Note: All specification subject to change without noticed.

PHYSICAL CHARACTERISTICS

DIMENSION:(mm)

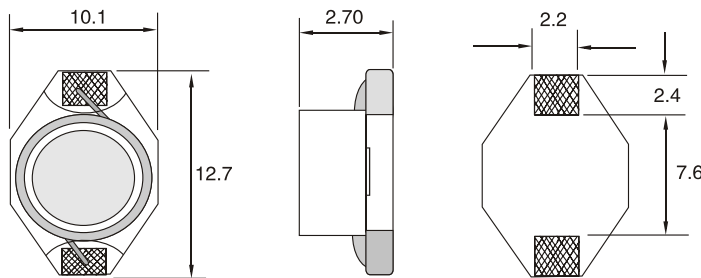

PAD LAYOUT

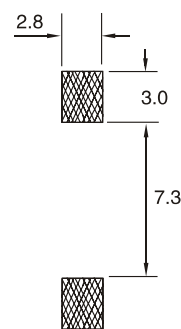

SHIELDED SURFACE-MOUNT POWER INDUCTORS

SPI0804S SERIES



FEATURES:

- Current up to 5A
- Very Small Foot Print
- Flat-top for Pick & Place

COMMON APPLICATIONS:

- Ideal for Palm-Top and Laptop DC-DC Converters
- PDA's Flash Memory
- Step-up, Step-down Converters

ELECTRICAL CHARACTERISTICS :

| Part Number SPI0802S- | L (μ H) $\pm 20\%$ | DCR (Ω) Max | IDC (A) Max |
|--------------------------|-----------------------------|----------------------|---------------|
| 1R0 | 1.0 | 0.021 | 5.0 |
| 1R5 | 1.5 | 0.022 | 4.5 |
| 2R2 | 2.2 | 0.032 | 3.8 |
| 3R3 | 3.3 | 0.039 | 3.3 |
| 4R7 | 4.7 | 0.054 | 2.7 |
| 6R8 | 6.8 | 0.075 | 2.2 |
| 100 | 10 | 0.101 | 2.0 |
| 150 | 15 | 0.150 | 1.5 |
| 220 | 22 | 0.207 | 1.3 |
| 330 | 33 | 0.334 | 1.1 |
| 470 | 47 | 0.472 | 0.80 |

- Testing: (Equivalent acceptable)
Inductance: HP4285A
RDC: QuadTech 1880 Milliohm meter
-Q- HP4342A - SRF-HP4191A
- IDC Max: Determined when superimposed DC current is decreased 10% against its initial value
- Operating Temperature: -40°C to $+85^{\circ}\text{C}$
- Storage Temperature: -40°C to $+105^{\circ}\text{C}$
- Solder methods: Vapor Phase, Infrared Reflow
- Resistance to soldering heat: 260°C for 10 seconds
- Solvent resistance: Conforms to MIL-STD-202E
- Marking: Inductance & Tolerance

PHYSICAL CHARACTERISTICS

DIMENSION:(mm)

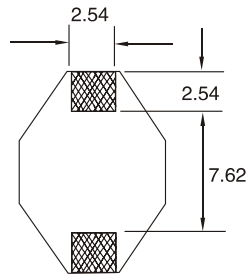
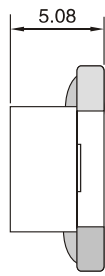
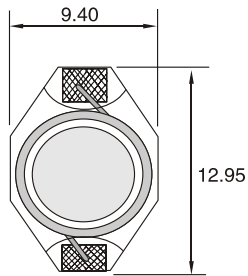

PAD LAYOUT

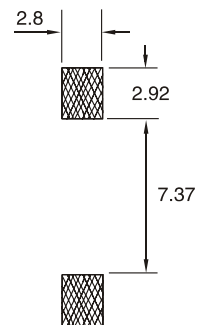

Notel: All specification subject to change without noticed.

SHIELDED SURFACE-MOUNT POWER INDUCTORS

SPI1306S SERIES



FEATURES:

- Current up to 3.9A
- Very Small Foot Print
- Flat-top for Pick & Place

COMMON APPLICATIONS:

- Ideal for Palm-Top and Laptop DC-DC Converters
- PDA's Flash Memory
- Step-up, Step-down Converters

ELECTRICAL CHARACTERISTICS :

| Part Number SPI1306S- | L (μ H) $\pm 20\%$ | DCR (Ω) Max | IDC (A) Max |
|--------------------------|-----------------------------|----------------------|---------------|
| 100 | 10 | 0.040 | 3.9 |
| 150 | 15 | 0.048 | 3.4 |
| 220 | 22 | 0.059 | 3.1 |
| 330 | 33 | 0.075 | 2.8 |
| 470 | 47 | 0.097 | 2.4 |
| 680 | 68 | 0.138 | 2.0 |
| 101 | 100 | 0.207 | 1.7 |
| 151 | 150 | 0.293 | 1.3 |
| 221 | 220 | 0.470 | 1.1 |
| 331 | 330 | 0.780 | 0.86 |
| 471 | 470 | 1.08 | 0.73 |
| 681 | 680 | 1.40 | 0.64 |
| 102 | 100 | 2.01 | 0.53 |

- Testing: (Equivalent acceptable)
Inductance: HP4285A
RDC: QuadTech 1880 Milliohm meter
-Q- HP4342A - SRF-HP4191A
- IDC Max: Determined when superimposed DC current is decreased 10% against its initial value
- Operating Temperature: -40°C to $+85^{\circ}\text{C}$
- Storage Temperature: -40°C to $+105^{\circ}\text{C}$
- Solder methods: Vapor Phase, Infrared Reflow
- Resistance to soldering heat: 260°C for 10 seconds
- Solvent resistance: Conforms to MIL-STD-202E
- Marking: Inductance & Tolerance

PHYSICAL CHARACTERISTICS

DIMENSION:(mm)

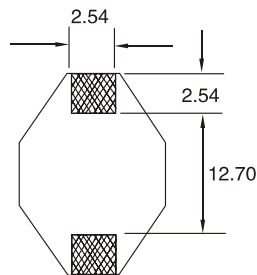
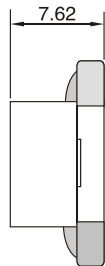
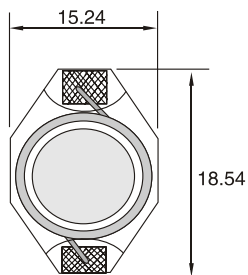

PAD LAYOUT

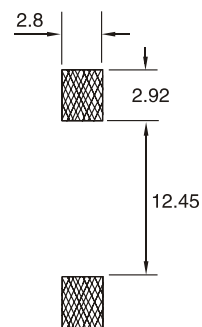

Note: All specification subject to change without noticed.